

IMPORTANT SAFEGUARDS

IT IS IMPORTANT TO READ AND UNDERSTAND ALL OF THE INSTRUCTIONS AND SAFEGUARDS PRIOR TO USE

- Save these instructions for future reference.
- The scale must be kept stable for accurate weighing.
- Do not drop, shock or overload the scale.
- Place items to be weighed onto the scale with care. Although the scale is designed to be durable, rough treatment may permanently damage the internal sensor.
- The weight of the item should not exceed the capacity of the scale (330 lbs/150 kgs.) Overloading the scale may cause damage.
- Items should be placed on the center of the scale when being weighed.
- Scale should be kept free of dust, dirt, moisture, vibration and not in close proximity to other electronic equipment. Any or all of these may cause an adverse effect on the reliability and accuracy of the scale.
- If “EEEE” appears on the display, then the item’s weight has exceeded the maximum capacity of the scale. Remove item immediately. Scale can be permanently damaged by overloading.
- Store scale in a cool dry place. Do not expose the scale to moisture.
- Avoid lengthy exposure to extreme heat or cold.
- Do not allow items to sit on scale platform for an extended amount of time. Doing so may have an adverse effect on the longevity and accuracy of the scale.
- Failure to follow these directions/precautions may result in damage to your scale and may void warranty.



ATTENTION

If any components of this unit are broken,
or if the unit does not operate properly,
please contact LEM Products at

1-877-536-7763

For more great products, log onto www.lemproducts.com



DIGITAL SCALE

Model # 1095



LEM Products
West Chester, OH 45011
Toll Free: 1-877-536-7763
www.lemproducts.com

KEY PAD FUNCTIONS

ON/OFF: Power switch

MODE : Change the weight unit between pounds and kilograms

LIGHT: Will turn off/on the backlight

TARE: This function is used to allow you to subtract the weight of a container.

1. Put container on scale.
2. When readout is stable press TARE.
3. Display will return to zero and allow you to add items to the container and obtain the weight of the items only, not the container.
 - a. Pressing TARE will reset the scale to zero. When the weight on the scale is below 16.5 lbs./7.5kg. pressing the tare button will reset the scale to zero. When the weight is greater than 16.5 lbs./7.5 kgs. and the TARE button is pressed, the TARE indicator will appear and display will show zero.

OPERATING INSTRUCTIONS

1. Place scale on a flat, stable surface.
2. Press the ON/OFF BUTTON on the display (#8).
3. Wait for the display to show 0.0. This may take several seconds.
4. Use the MODE BUTTON on the display to change the reading from lbs. or kgs.
5. Place the item to be weighed in the center of the stainless steel top (#5). Items must have a weight of 1.1 lb. or more to register.
6. Weight of item will be displayed.
7. Remove item from scale.

CLEANING

Clean with a damp cloth and mild detergent.

Never immerse unit, display or cord in water or other liquids.

INACCURACY/ERROR

The primary reasons for inaccuracy or malfunctions are low batteries, incorrect calibration, overload or operation on an unstable surface. This scale is a precise instrument and must be handled with the utmost care.

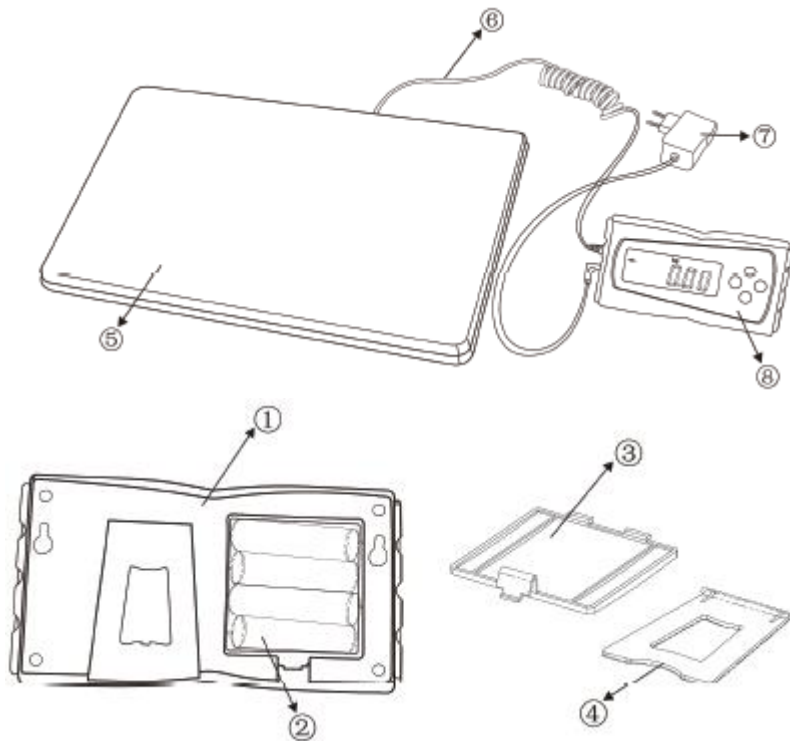

Part #	Description	Qty	Part #	Description	Qty
1	Display Back	1	6	Cable	1
2	Battery	4	7	Adaptor	1
3	Battery Cover	1	8	Display Front	1
4	Display Bracket	1	9	Feet (not shown)	4
5	Stainless Steel Top	1			

SCALE FEATURES

Capacity: 330 lbs/150 kgs.

Graduation: 0.1 lbs. / 0.05 kgs.

Battery operated: 4 AA batteries (included)

Power cord: 10' (included)

Cable: 10' fully extended

Luminescent backlight display (or turned off for battery saving)

Battery saving auto shut off (2 minutes)